

## FEATURES

- Precision measuring system
- High resolution dial
- Knife Edge pointer
- Anti-parallax mirror band
- Jewel bearing movement
- Easy to read scale

## APPLICATION

- Calibration & testing labs
- Calibration & testing of industrial pressure gauges

### SS Case



### STANDARD PARAMETERS

|                     |   |                                       |
|---------------------|---|---------------------------------------|
| Accuracy            | : | CL 0.25                               |
| Ambient temperature | : | 20... +65°C                           |
| Service temperature | : | 65°C max.                             |
| Pressure limits     | : | Steady pressure up to 75% of FS value |
| Weld joints         | : | Silver alloy brazing                  |

### MATERIAL OF CONSTRUCTION

|                          |   |   |
|--------------------------|---|---|
| Sensing element          | : | Bourdon Tube (<100 bar : C - type , > 100 bar : Helical)          |
| Case & Ring material     | : | AISI 304 SS (Bayonet type)  |
| Bourdon tube             | : | Beryllium Copper  |
| Shank                    | : | Copper alloy  |
| Integral dampening screw | : | Copper alloy  |
| Movement mechanism       | : | High precision (Jewel bearing type)                               |
| Dial                     | : | Aluminum, green with black marking<br>& anti-parallax mirror band |
| Pointer                  | : | Balanced, knife-edge micrometer adjustable                        |
| Pointer stopper          | : | Spring type   |
| Gaskets & Blow off disc  | : | NBR   |
| Window                   | : | Safety glass  |

### STANDARD SPECIFICATIONS

|                         |   |  |
|-------------------------|---|--|
| Dial size               | : | DN150 / DN250  |
| Range                   | : | -1...700 bar   |
| Mounting pattern        | : | Direct, Bottom connection  |
| Process connection      | : | 1/2" NPT (M) / 1/2" BSP (M)  |
| Ingress protection      | : | IP 65  |
| Execution               | : | Dry  |
| Carrying case           | : | Pine wood carrying case  |
| Calibration certificate | : | Calibration certificate traceable up to National & International standards |

### TEMPERATURE EFFECT

When temperature of the measuring system deviates from reference temperature (+20°C) max error  $\pm 0.4\%$  / 10K of true scale value.

## REFERENCE

EN 837-1

DIMENSIONAL DRAWING

Type B0

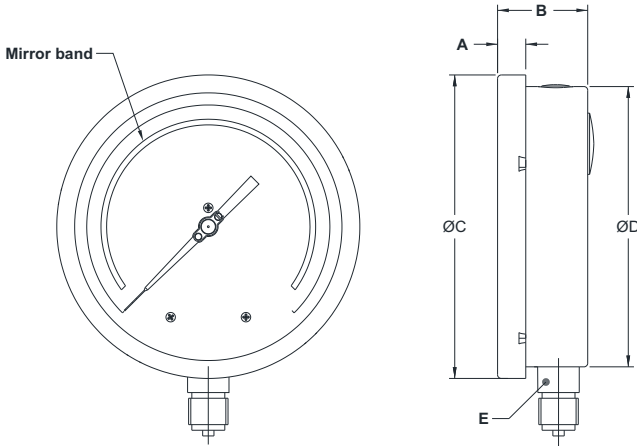

| DN  | A    | B  | ØC  | ØD  | E     | Weight (grams) |
|-----|------|----|-----|-----|-------|----------------|
| 150 | 15   | 48 | 161 | 149 | SQ.22 | 950            |
| 250 | 18.5 | 50 | 263 | 250 | SQ.22 | 2150           |

Type B1

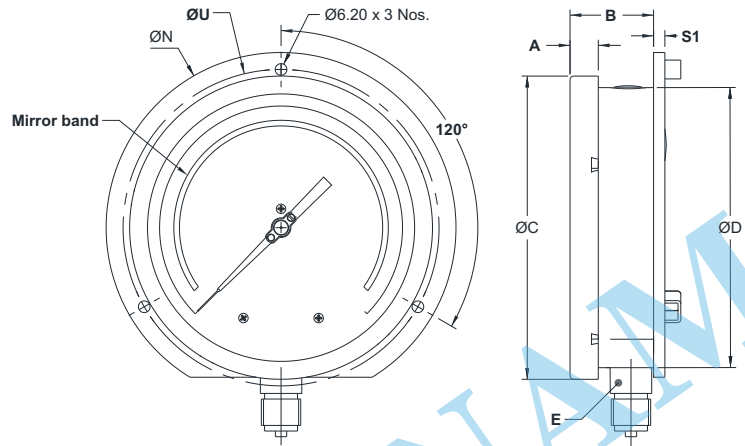

| DN  | A    | B  | ØC  | ØD  | E     | ØI | M     | ØN  | S1  | ØU  | Weight (grams) |
|-----|------|----|-----|-----|-------|----|-------|-----|-----|-----|----------------|
| 150 | 15   | 46 | 161 | 149 | SQ.22 | 6  | 172.4 | 186 | 6   | 168 | 1065           |
| 250 | 18.5 | 48 | 263 | 250 | SQ.22 | 7  | 286.5 | 290 | 1.5 | 276 | 2375           |

Type L0

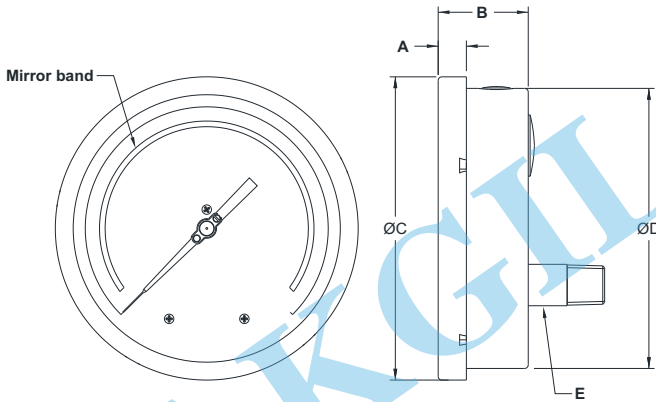

| DN  | A    | B  | ØC  | ØD  | E     | Weight (grams) |
|-----|------|----|-----|-----|-------|----------------|
| 150 | 15   | 48 | 161 | 149 | SQ.22 | 950            |
| 250 | 18.5 | 50 | 263 | 250 | SQ.22 | 2150           |

Type L1

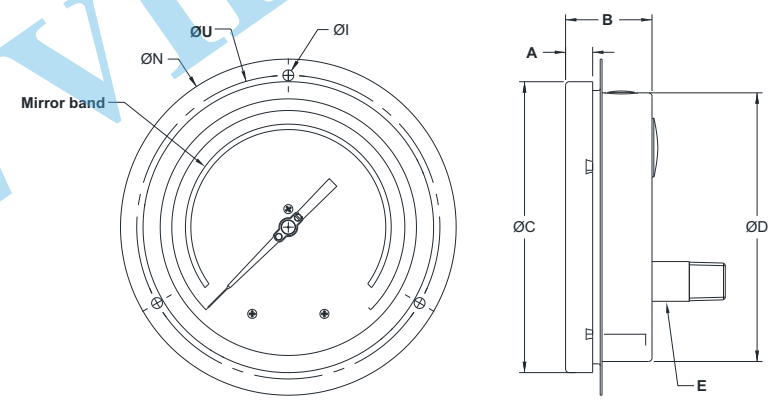

| DN  | A    | B  | ØC  | ØD  | E     | ØI | ØN  | ØU  | Weight (grams) |
|-----|------|----|-----|-----|-------|----|-----|-----|----------------|
| 150 | 15   | 48 | 161 | 149 | SQ.22 | 6  | 186 | 168 | 1066           |
| 250 | 18.5 | 50 | 263 | 250 | SQ.22 | 7  | 290 | 276 | 2350           |

Type L2

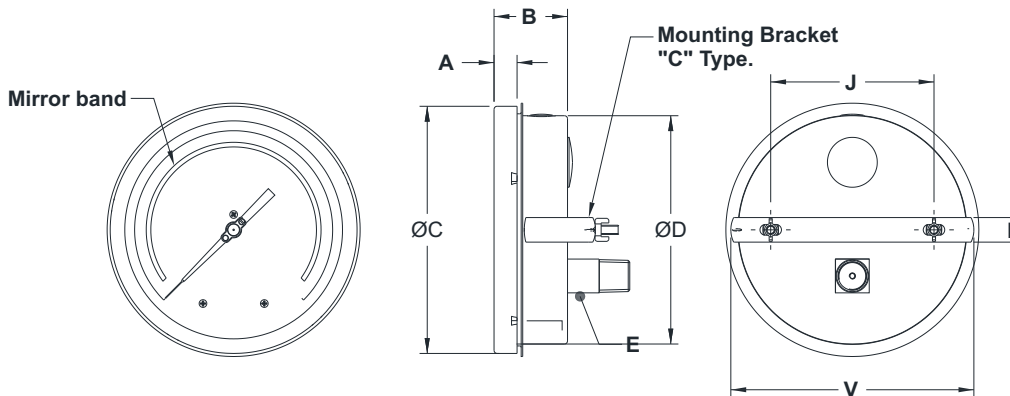

| DN  | A    | B  | ØC  | ØD  | E     | J     | K  | V     | Weight (grams) |
|-----|------|----|-----|-----|-------|-------|----|-------|----------------|
| 150 | 15   | 48 | 161 | 149 | SQ.22 | 106.5 | 16 | 158.5 | 1150           |
| 250 | 18.5 | 50 | 263 | 250 | SQ.22 | 180   | 30 | 270   | 2450           |

All dimensions are in mm.

**ORDERING CODES**

**1. DIAL SIZE**

- 06** 150 mm / 6"
- 10** 250 mm / 10"

**06**

**2. RANGE**

- XXX** Refer "Range Table"

**XXX**

**3. MOUNTING PATTERN**

- B0** Direct, Bottom connection
- B1** Wall/Surface/Projection mounting, Bottom connection
- L0** Lower, Back connection
- L1** Panel/Front flange mounting, Lower Back connection
- L2** Panel/bracket mounting, Lower Back connection

**B0**

**4. PROCESS CONNECTION**

- 12N** 1/4" NPT (M)
- 14N** 1/2" NPT (M)
- 14B** 1/2" BSP (M)
- 14M** M20 X 1.5 mm (M)

**14N**

**5. INGRESS PROTECTION**

- ER** IP 65

**ER**

**6. EXECUTION**

- EA** Dry

**EA**

**7. OTHER OPTIONS**

- EN** Dampening screw, AISI 316 SS
- MA** Cu-Alloy Shank
- MF** AISI 316 SS shank
- XF** SS tag plate, AISI 304 SS
- XR** Custom designed dial
- XT** Dial tag marking

**XX**

**8. ACCESSORIES**

- A202** Gauge saver
- A201** Gauge snubber

**Ordering Example : P801-06-XXX-B0-14N-ER-EB**

**NOTES**

1. For other connections, please contact factory.